



# Datasheet

**Reference : 754299**

IGNITION :

Ignition unit : ACI 100 MAGNETI MARELLI  
Spark plug : NGK BR8ES or EYQUEM R1000L  
Electrode gap : 0,6 to 0,7 mm  
Ignition advance : variable  
Ignition coil : TEC MP11 or T11C X7A  
Primary winding resistance : 0,26Ω ± 20%  
Secondary winding resistance : 3KΩ ± 20%  
Spark plug cap resistance : 5KΩ ± 10%  
Pick-up resistance : 120Ω ± 10%

ELECTRICAL EQUIPMENT :

Current generator (type and power) : GF10 - 232 - 90W  
Make : MITSUBA  
Stator resistance : yellow wire 0,6Ω ± 25% -  
white wire 0,7Ω ± 25%  
Battery regulation voltage : 14,5 ± 0,5V  
Battery (type and capacity) : YT5L-BS 12V 4Ah  
Lighting voltage : alternating current regulation at : 13,1 ± 0,5V

STARTER :

Power and type : 300W SM 5  
Make : MITSUBA

LIGHTING AND FUSES :

Headlamp (code light) :	2	12V - 35/35W
Rear stop lamp :	1	12V - 21/5W
Indicator lamps :	4	12V - 10W
Number plate lightning :	1	12V - 5W
Dash board lighting :	3	12V - 1,2W
Instrument panel indicator lamps :	3	12V - 1,2W
Main fuse :	1	5A
Signalling fuse :	*	*
“Side light” bulb :	2	12V - 5W

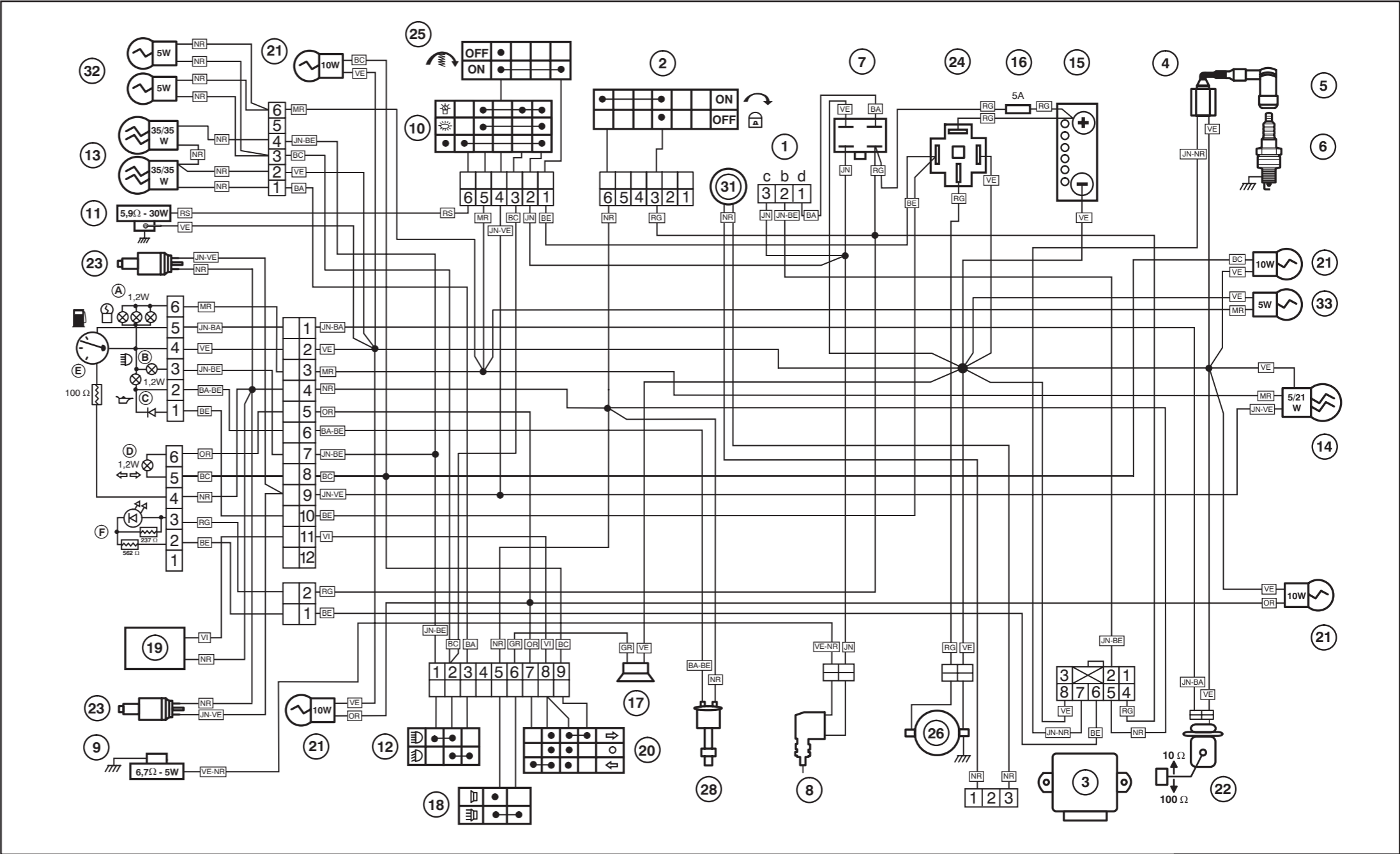
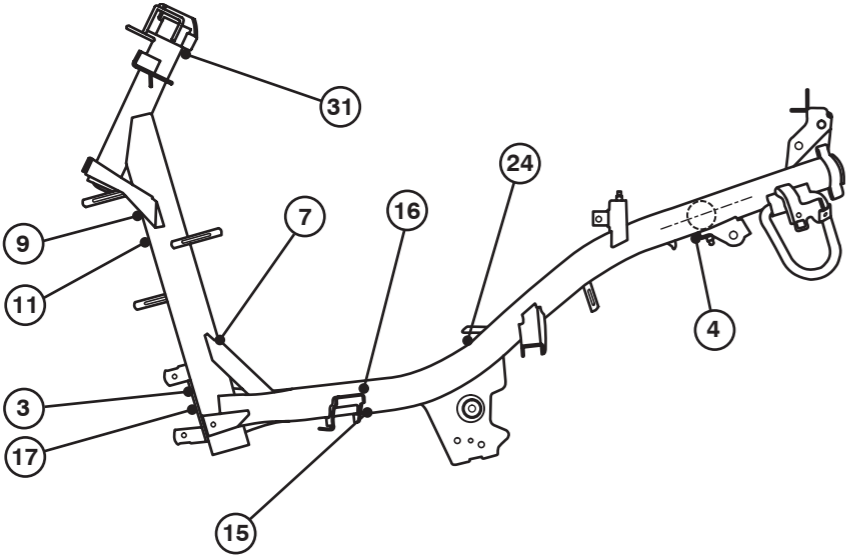

- A Instrument panel lightning

B Main beam control

C Oil level warning light

D Indicator control light

E Fuel gauge

F LED “Anti-theft device”

G Temperature gauge

H Warning light “Reserve”

J Oil-pressure warning light
- 1) Generator

a : Ignition coil (inner)

b : Pickup

c : Alternating current

d : Battery charge current
- 2) Ignition switch

3) CDI Unit

4) Ignition coil (high voltage)

5) Spark plug socket (resistive) 5 KΩ

6) Spark plug (resistive) 5 KΩ
- 7) Regulator - rectifier

(A): Regulator AC

(B): (Regulator) - rectifier DC

8) Automatic choke

9) Resistor (in line with choke)

6,7 Ω - 5 W

10) Light switch

11) Resistor (parallel to lightning)

5,9 Ω - 30 W

12) Dip switch (main / low headlight)

13) Headlight

14) Stop- / tail-light

15) Battery

16) Fuse

17) Horn

18) Horn switch

19) Indicator relay

20) Indicator switch

21) Indicator bulb

22) Fuel gauge pickup
- 23) Stop light switch

24) Starter relay

25) Starter switch

26) Starter motor

27) Current limiter

28) Oil level switch

29) Temperature sensor

30) Immobilizer

31) Antenna for anti-theft device

32) “Side light” bulb

33) Number plate light

34) Lateral stand switch

35) Emergency switch (ignition)

36) “Neutral” switch (gearbox)

37) Oil pressure switch

38) Cooling fan

39) Thermo-switch cooling fan

40) Electrical carburettor heating

41) Power supply unit

42) Switch “Reserve”

- BA :

BA-BE :

BA-NR :

BC :

BE :

GR :

JN :

JN-BA :

JN-VE :

JN-NR :

JN-VE :

MR :

NR :

OR :

RG :

RG-NR :

RS :

VE :

VE-NR :

VI :
- White

White/Blue

White/Black

Light Blue

Blue

Grey

Yellow

Yellow/White

Yellow/Green

Yellow/Black

Yellow/Green

Brown

Black

Orange

Red

Red/Black

Pink

Green

Green/Black

Purple